

# CONFERENCE PACKAGES

2025





# TABLE OF CONTENTS

INTRODUCTION	04
--------------	----

SMITH & DERUIT ROOM	05
---------------------	----

CHARLES MARSHALL ROOM	06
-----------------------	----

DUNCAN REILLY ROOM	07
--------------------	----

DAY DELEGATE PACKAGE	08
----------------------	----

STAY DELEGATE PACKAGE	09
-----------------------	----

EQUIPMENT	10
-----------	----

MORNING AND AFTERNOON TEA	12
---------------------------	----

LUNCH PACKAGES	13
----------------	----

HOT AND COLD CANAPES	14
----------------------	----

BUFFET	15
--------	----

A LA CARTE	16
------------	----

BEVERAGE OPTIONS	17
------------------	----

CONTACT US	18
------------	----







# INTRODUCTION

Melbourne Metropole Central is located on vibrant Brunswick Street, Fitzroy — just 8 minutes from the Melbourne CBD. Our recently refurbished venues provide the perfect setting for meetings, workshops, and corporate functions.



## 15–180 Delegates

Our spaces comfortably accommodate groups from 15 to 180 guests.



## Variety Of Room Types

Choose from a range of rooms to suit meetings, workshops, or events.



## Flexible Catering Packages

Enjoy tailored catering options from our in-house Metropole Cafe.



## Free Wi-Fi

Stay connected with complimentary Wi-Fi throughout the venue.



## Secure Undercover Parking

On-site secure parking is available for your convenience. Fees may apply.



## Audio-Visual Equipment Hire

We provide AV equipment to enhance your presentations.

# SMITH & DERUIT ROOM

The Smith & Deruit room is a boardroom setting perfect for small meetings and events, seating up to 16 delegates.

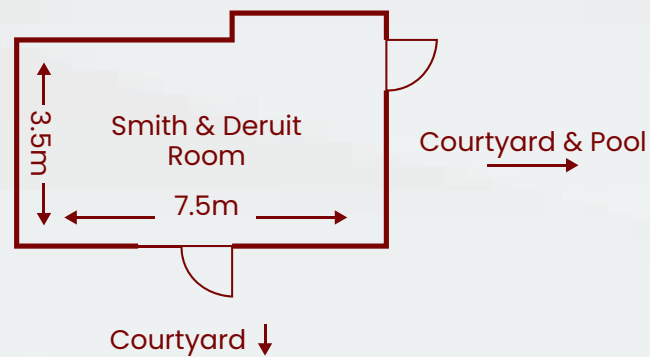

## CONFIGURATIONS AND CAPACITIES

RECEPTION	THEATRE	U-SHAPE	BOARDROOM	CLASSROOM	BANQUET
20	16	-	12	12	-

## ROOM HIRE

Weekday (Monday - Friday)

\$250

Weekend & Public Holidays

\$350







## CHARLES MARSHALL ROOM

The Charles Marshall Room is a versatile space that can accommodate up to 80 delegates. It offers ample natural light and an outlook of the courtyard and pool.

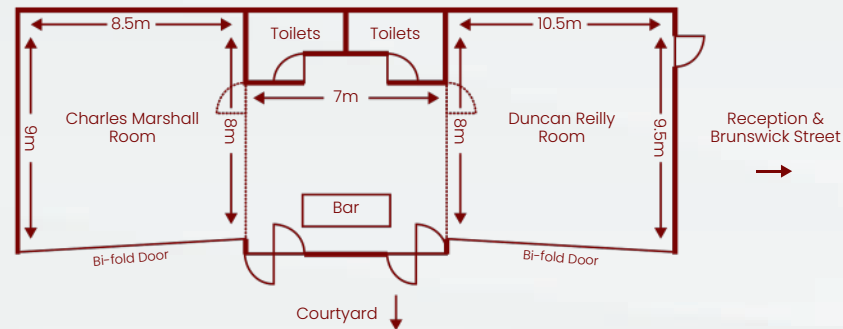

### CONFIGURATIONS AND CAPACITIES



RECEPTION

100



THEATRE

80

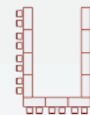

U-SHAPE

30



BOARDROOM

36



CLASSROOM

40

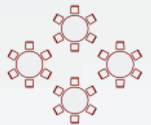

BANQUET

60

### ROOM HIRE

#### Weekday (Monday - Friday)

**\$450**

full day

**\$280**

half day

#### Weekend & Public Holidays

**\$550**

full day

**\$380**

half day

# DUNCAN REILLY ROOM

The Duncan Reilly Room is a flexible space for up to 100 delegates. Bi-fold doors open to the courtyard, bringing in natural light and creating outdoor breakout areas.

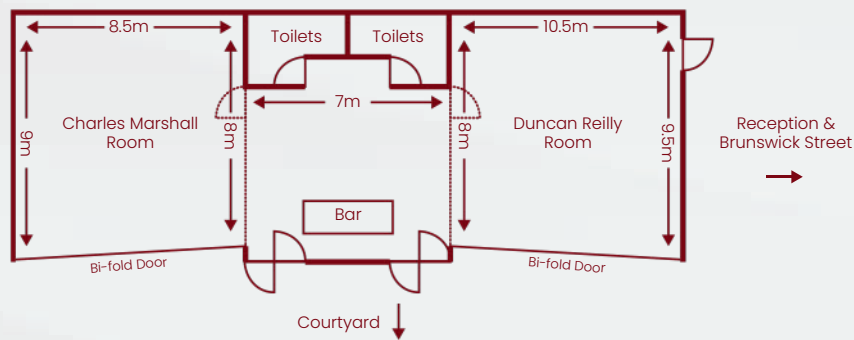

## CONFIGURATIONS AND CAPACITIES

RECEPTION	THEATRE	U-SHAPE	BOARDROOM	CLASSROOM	BANQUET
100	100	36	40	70	70

## ROOM HIRE

### Weekday (Monday - Friday)

\$500	\$300
full day	half day

### Weekend & Public Holidays

\$600	\$400
full day	half day







## DAY DELEGATE PACKAGE

Our Day Delegate Package is perfect for one-day events. It includes room hire, catering, parking, and AV equipment, with tea and coffee served morning and afternoon, plus a varied lunch spread.

### PACKAGE INCLUSIONS\*



#### Room Amenities

Room Hire  
Notepads and Pens  
Iced Water and Mints



#### Catering

Tea, Coffee & Fruit Juice on Arrival  
Morning & Afternoon Tea & Coffee  
Combo Lunch Deal



#### Car Parking

Car Parking for all Delegates



#### Audio Visual

Projector & Projection Screen  
Flip Chart with Paper and Markers  
Whiteboard and Markers

### PACKAGE RATES

#### Weekday (Monday - Friday)

\$95 per person

#### Weekend & Public Holidays

\$99 per person

*\*minimum 10 delegates*



# STAY DELEGATE PACKAGE

The Stay Delegate Package includes accommodation in single studios or shared two-bedroom apartments, along with catering, room hire, and AV equipment.

## PACKAGE INCLUSIONS\*



### Room Amenities

Room Hire  
Notepads and Pens  
Iced Water and Mints



### Accommodation

Single Studio Apartment or  
Shared 2-Bedroom Apartment  
Car Parking for all Delegates



### Audio Visual

Projector & Projection Screen  
Flip Chart with Paper and Markers  
Whiteboard and Markers



### Catering

Tea, Coffee & Fruit Juice on Arrival  
Buffet Breakfast  
Morning & Afternoon Tea & Coffee  
Cold Working Lunch  
Buffet or Alternate Dinner Menu

**CONTACT FOR PRICING**

*\*minimum 20 delegates*





# EQUIPMENT

Additional equipment is available on request. Charges may apply.

Equipment	Price
Data Projector	\$150
Whiteboard & Markers	\$50
Lectern	\$NA
Flip-Chart, Butchers Paper & Markers	\$40
Notepad & Pen	\$5 per person
Audio Equipment Microphone & Speaker	\$150



A person in a white shirt is serving food from a buffet line. They are using a silver spoon to scoop food into a white bowl. The buffet line is filled with various dishes, including green vegetables, red tomatoes, and white rice. The person is standing behind a long table covered with a white tablecloth. The background is slightly blurred, showing other people and more food. The text "CATERING PACKAGES" is overlaid on the left side of the image in a large, white, sans-serif font.

# CATERING PACKAGES



## MORNING & AFTERNOON TEA

Our package includes tea and coffee served all day, plus a wide selection of food options.

Select one item for morning tea and one item for afternoon tea.

- Carrot Cake
- Banana Bread
- Homemade Biscuits
- Assorted Muffins
- Savoury Scones
- Fresh Fruit Platter
- Scones with Jam and Cream
- Danish Pastries

### PACKAGE RATES

**\$30** per person

includes continuous tea and coffee



## LUNCH PACKAGES

All lunch packages include a seasonal fruit platter, fruit juice, water, and soft drinks. Traditional fillings and vegetarian options are available.

Minimum 25 guests.

### COLD WORKING LUNCH

choose one of the following:

- Farmhouse Sandwiches
- Baguettes
- Assorted Wraps (on request – \$5 surcharge)
- Juice and Soft Drinks
- Fresh Fruit Platter

### PACKAGE RATES

#### Cold Working Lunch

**\$35** per person

### HOT WORKING LUNCH

choose three/four of the following:

- Chicken & Leek Pie
- Gnocci with Pumpkin & Sage
- Beef Ragu (Gnocci or Penne)
- Soup of the Day
- Assorted Side Salads
- Crusty Bread

#### Hot Working Lunch

**\$45** per person for 3 items

**\$50** per person for 4 items

*Please discuss tailored requirements with our conference coordinator*





## HOT AND COLD CANAPES

Enjoy a large selection of finger food with hot and cold canapés.

Minimum 25 guests.

### SAVOURY OPTIONS

- Bruschetta
- Meatballs with tomato & basil sugo
- Crispy Japanese prawn & vegetable gyoza
- Tiger prawns with chilli & baby basil
- Meat or vegetarian arancini
- Roast Pumpkin & Sage Croquettes
- Vegetable spring rolls with sweet chilli sauce
- Grilled lamb cutlets with garlic, thyme & tomato relish
- King prawns on skewers with romesco & lime sauce
- Mini hamburgers
- Tasmanian smoked salmon roulade on French crepes
- Poached prawn salad with chevril aioli on sweet buns
- Duck pancakes with hoisin dipping sauce
- Salt & pepper crusted calamari with garlic
- Fillet Mignon with Béarnaise

### PACKAGE RATES

#### 6 Items

\$45 per person

#### 9 Items

\$55 per person

#### 12 Items

\$65 per person

### SWEET OPTIONS

- Lemon Meringue
- Mini Tartlets (variety)
- Berry Cheesecake
- Profiteroles

*Gluten-free & vegan options available.*



# BUFFET

The buffet option includes a carvery with salads and sides, plus the option of dessert. Minimum 30 guests required.

## CARVERY

- Roasted Angus Beef
- Rosemary-spiked Leg of Lamb
- Steamed whole Tasmanian salmon
- French-cut chicken breast with lemon & oregano
- Seafood (may be available at market price)
- Crusty Seeded White Bread Rolls
- Italian potatoes with garlic, olive oil & fresh herbs

## DESSERTS (ADD \$10 PER PERSON)

- Homemade Chocolate Mousse
- Bread + Butter Pudding
- Sticky Date Pudding
- Fresh Fruit Platter

## BUFFET RATES

### Option 1

from \$ **55** per person

### Option 2

from \$ **65** per person

Includes canapes on arrival and desserts

## SALADS & SIDES

- Tomato basil & Bocconcini Salad
- Mediterranean Pasta & Vegetables
- Lentils, Beetroot & Fetta
- Raddichio, Mesclum & Avocado
- Caesar Salad
- Caramelized Butternut Pumpkin
- Roasted zucchini, Egg plant & Bell peppers



*Gluten-free & vegan options available.*

# A LA CARTE

Personalised dining packages with canapés and 1, 2, or 3 course options for 10 or more guests.

## Canapés (select 3 from Canapés Menu)

\$15 per person

### 1 Course

from \$39 per person

### 2 Course

from \$55 per person

### 3 Course

from \$69 per person



*Gluten-free & vegan options available.*



# BEVERAGE OPTIONS

Enjoy a wide range of beer, wine, spirits, and soft drinks with our beverage packages. Packages are available for two or three hours. Minimum 25 guests.

## BEVERAGES AVAILABLE

- Selected White and Red Wines
- Sparkling Wines
- Selected Imported and Australian Full Strength Beers
- Selected Australian Light Beers
- Juice and Soft Drinks
- All Spirits POA

## BEVERAGE RATES

### Option 1 (3 hour service)

**\$45** per person

Standard Beer, Wine & Soft Drinks

### Option 2 (3 hour service)

**\$65** per person

Beer, Wines, Spirits & Soft Drinks

### Option 3 (3 hour service)

**Pay As You Go**



*Gluten-free & vegan options available.*

# CONTACT US



03 9411 8100



<https://www.cagconferences.com.au/>



[conferences@metropolecentral.com.au](mailto:conferences@metropolecentral.com.au)



44 Brunswick Street, Fitzroy, Victoria, 3065, Australia









## HEAD OFFICE

Alison House 35 Dover Street Albion QLD 4010

07 3852 3334

[www.cagl00.com.au](http://www.cagl00.com.au)

*No responsibility is accepted by Prime Group Australasia or its subsidiary Central Apartment Group Pty Ltd or the author of this brochure for the accuracy of any information contained herein or for any action taken in reliance thereon. This information is provided to you in good faith as of July 2022 by Prime Group Australasia and its subsidiary Central Apartment Group Pty Ltd and in no way has set out to deceive prospective clients. Copyright – This report cannot be reproduced without formal approval of Prime Group Australasia. Copyright 2022 Prime Group Australasia and subsidiary Central Apartment Group Pty Ltd.*